

28 Richeson Walk, Henbury, Bristol, BS10 7BD

Sold @ Auction £180,000



- FOR SALE BY ONLINE AUCTION
- WEDNESDAY 14TH OCTOBER 2020
- VIDEO TOUR NOW ONLINE
- VIEWINGS - REFER TO DETAILS
- DOWNLOAD ONLINE LEGAL PACKS
- OCTOBER 2020
- FREEHOLD HOUSE
- WOOLAWAY CONSTRUCTION
- REQUIRES BASIC UPDATING
- EXTENDED 8 WEEK COMPLETION

Hollis Morgan - OCTOBER LIVE ONLINE AUCTION - A Freehold semi detached HOUSE (1060 Sq Ft) in need of BASIC UPDATING and currently LET for £11,220 pa *** CASH BUYERS ONLY *** located close to BLAISE CASTLE.

28 Richeson Walk, Henbury, Bristol, BS10 7BD

Accommodation

ADDRESS

28 Richeson Walk, Henbury, BS10 7BD

FOR SALE BY LIVE ONLINE AUCTION

*** SOLD BY LIVE ONLINE AUCTION ***

GUIDE £140,000 +++
SOLD @ £180,000

Lot Number 15

The Live Online Auction is on Wednesday 14th October at 18:00
Registration Deadline is Monday 12th October

The sale will be streamlined LIVE ONLINE and you can BID by telephone, proxy or via your computer with your unique bidding PIN. Registration is a simple 3 step process – download the online auction buyers guide for further details
Or simply email bid@hollismorgan.co.uk

EXTENDED COMPLETION

Completion is set for 8 weeks or earlier subject to mutual consent.

VIEWINGS

Viewings can be booked on specific days for this property – please submit a viewing request online and we will contact you to arrange access. Hollis Morgan would be grateful if you could arrive promptly to inspect the properties at the START of the agreed time as we have scheduled viewings throughout the day and CANNOT wait for late arrivals.

There are likely to be viewings on the property before and after your appointment and if you miss your slot (usually 15 minutes or longer for larger properties) you will be asked to wait until the next available time. Please note government regulation on groups sizes and safe social distancing must be practiced at all times – please bring your own gloves and facemask.

You may be asked to wait outside before it is safe to enter – please understand and respect this request.

If you have shown any symptoms of Covid (19) in the last 10 days we would respectfully ask you to not attend the viewing.

The safety of our clients and staff is our number one priority and we thank you for your understanding.

Please note that hard copy of details will not be provided but will have been emailed to you with instructions on how to bid and what happens next before the viewing.

SOLICITORS

Sarah Baldwin
Lyons Bowe Solicitors
sarah.baldwin@lyonsbowe.co.uk
tel:01749 345 756

Floor plan

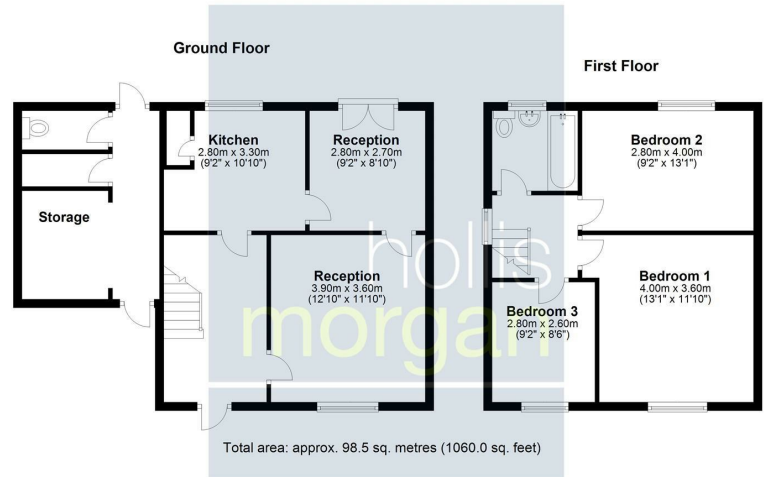
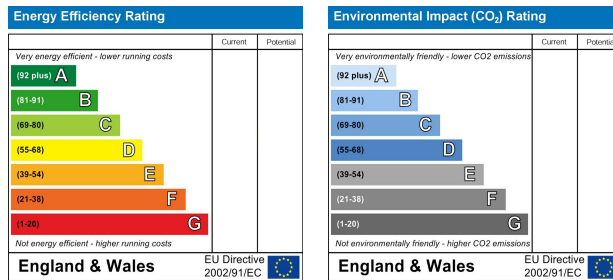

Illustration for identification purposes only, measurements are approximate, not to scale.
This plan has been created using previous drawings as reference material, therefore the accuracy of information cannot be guaranteed.
Floorplan Produced by Westcountry EPC
Plan produced using PlanUp.

EPC Chart



9 Waterloo Street
Clifton
Bristol
BS8 4BT

Tel: 0117 973 6565
Email: post@hollismorgan.co.uk
www.hollismorgan.co.uk

Hollis Morgan Property Limited, registered in England, registered 7275716.
Registered address, 5 Upper Belgrave Road, Clifton, Bristol BS8 2XQ

Auction Property Details Disclaimer

Hollis Morgan endeavour to make our sales details clear, accurate and reliable in line with the Consumer Protection from Unfair Trading Regulations 2008 but they should not be relied on as statements or representations of fact.

Please refer to our website for further details.